

High Quality Wood Frame Instructions

1

Get the arch out of the box and lay out the details as in the graphic, where the side with a square cutout is the front. **WARNING!** Should appear a trapezoidal shape.

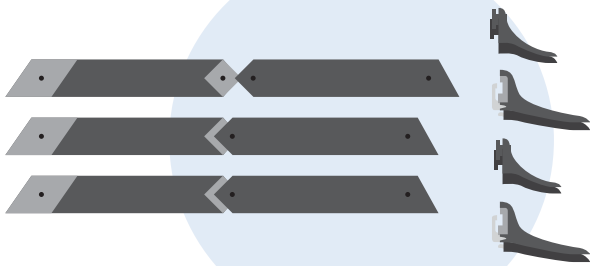

2

Use a bolt and screw to connect the parts together (Front view, back view)

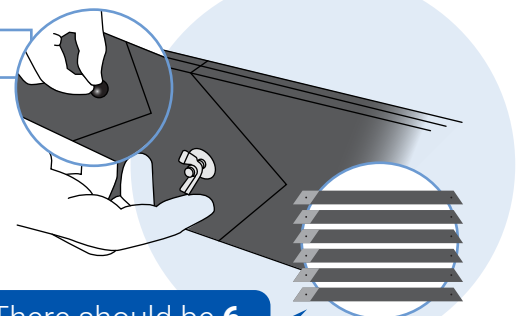

There should be **6** such elements

3

Lay out the parts, giving them the final shape of the Arch and connect with a bolt and screw. **WARNING!** The square cut is the facade.

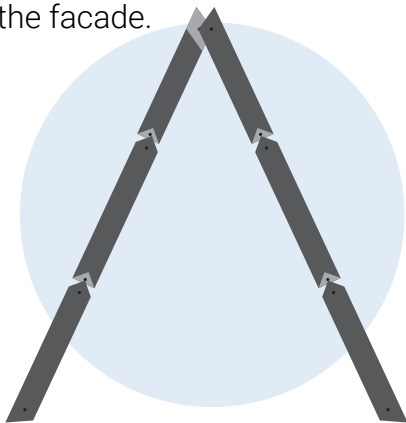

4

Place the stands in front of each other and place the Arch on the stands.

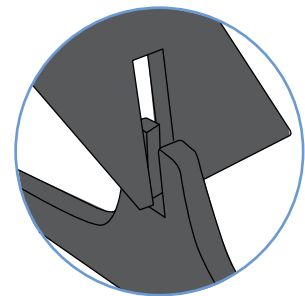

6

Instaling requires 2 people and 10 minutes of work

